

TYPICAL CROSS SECTION
PROPOSED DRIVEWAY
no scale

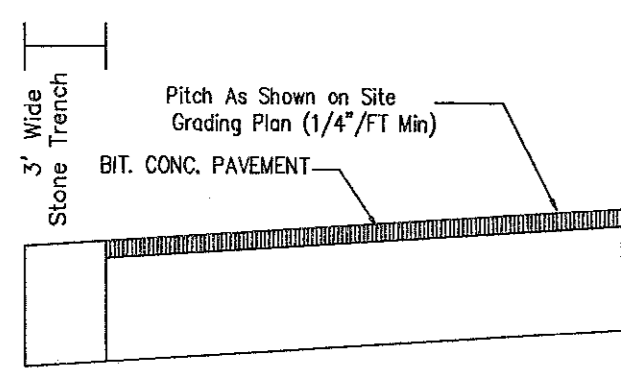

DETAIL
SILT SOCK FOR EROSION CONTROL

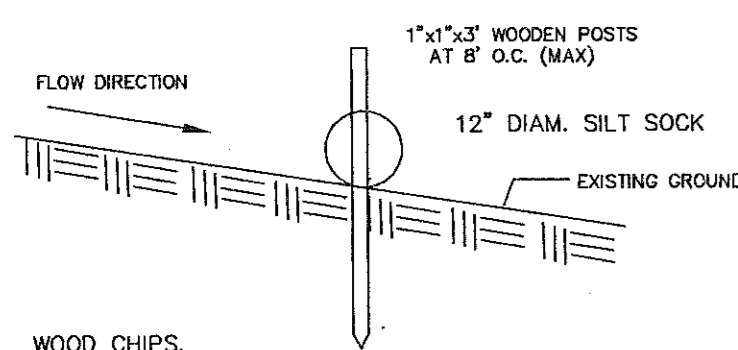

WOOD CHIPS.
UPSTREAM CONTRIBUTORY AREA SHALL NOT EXCEED .25 AC. PER 100 LF OF SOCK FOR 12" DIAM. SILT SOCK SHALL BE FILLED WITH A MIX OF 30-40% WEED FREE COMPOST AND 60 TO 70 %

DETAIL
DRIP EDGE

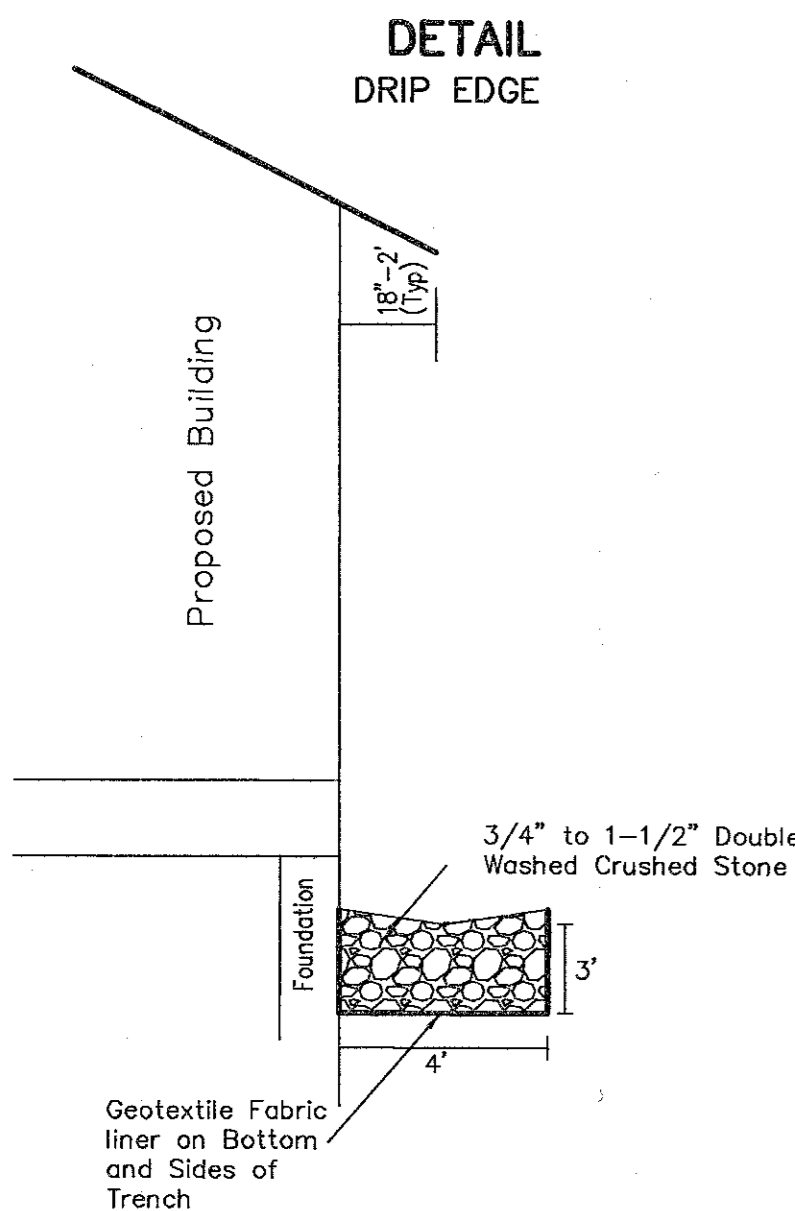

SECTION
THROUGH PROPOSED GARAGE

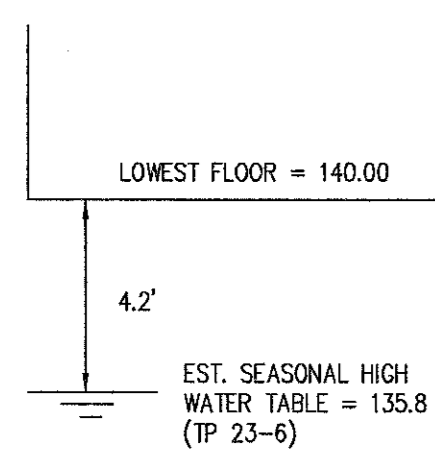

LEGEND

- SMH EXISTING SEWER MANHOLE
- WG EXISTING HYDRANT
- WG EXISTING WATER GATE
- WSO EXISTING WATER SHUTOFF
- GAS EXISTING GAS GATE
- EXISTING UTILITY POLE
- EXISTING FENCE
- EXISTING WALL
- EXISTING SPOT GRADE
- EXISTING CONTOUR
- PROPOSED CONTOUR
- PROPOSED SPOT GRADE
- PROPOSED EROSION CONTROL
- PROPOSED ROOF DRAIN
- △ B4 RESOURCE AREA FLAG
- ◆ 23-3 SOIL TEST PIT

DETAIL
DRIVEWAY INFILTRATION TRENCH
no scale

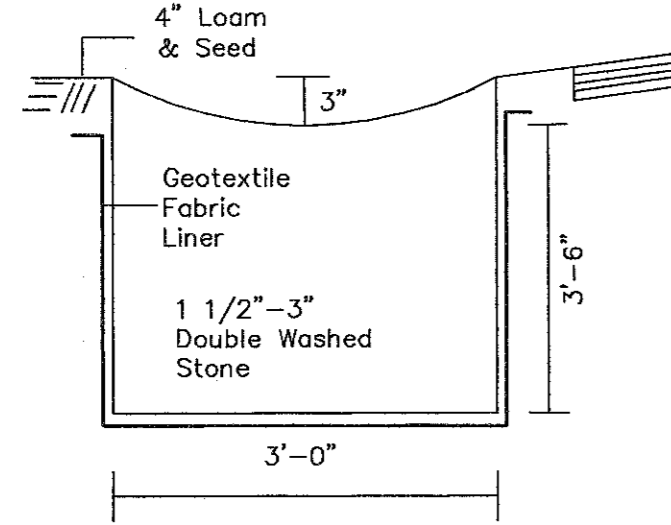

ROOF DRAIN CONNECTION
WITH OVERFLOW WYE
no scale

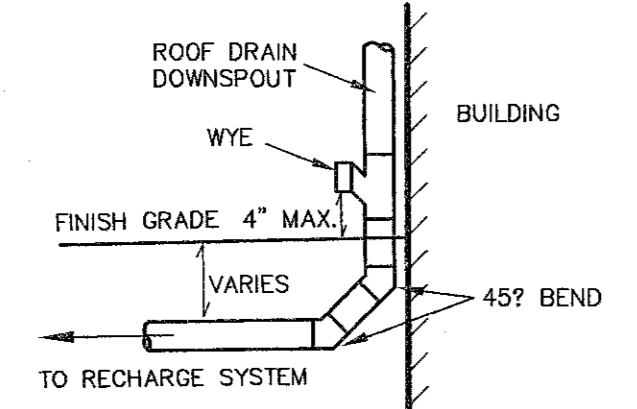

LOW PRESSURE SEWER
TRENCH SECTION
no scale

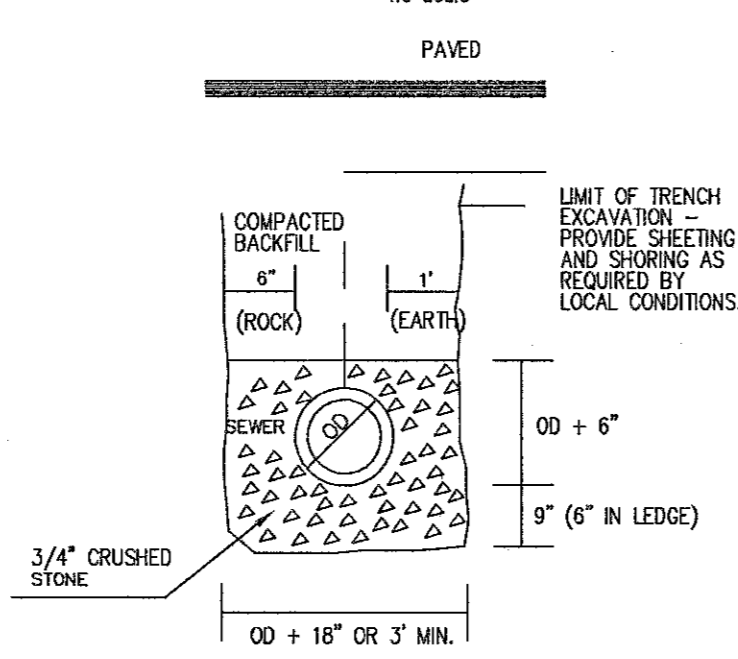

WATER SERVICE
TRENCH SECTION
no scale

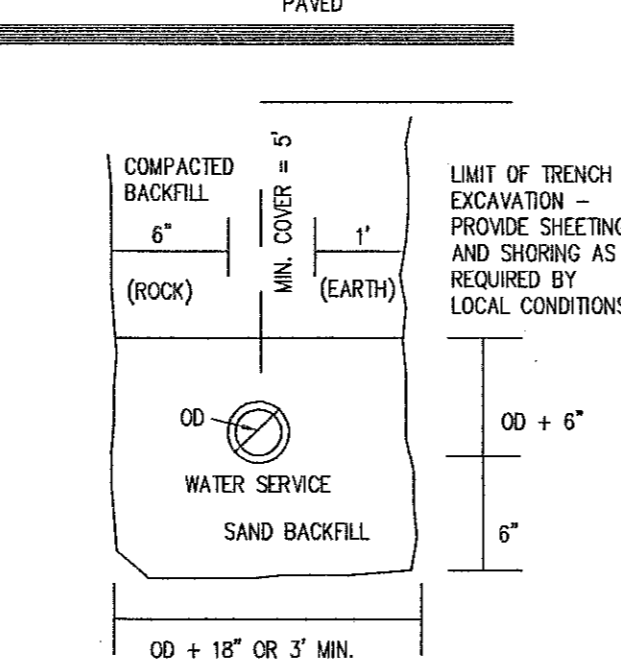
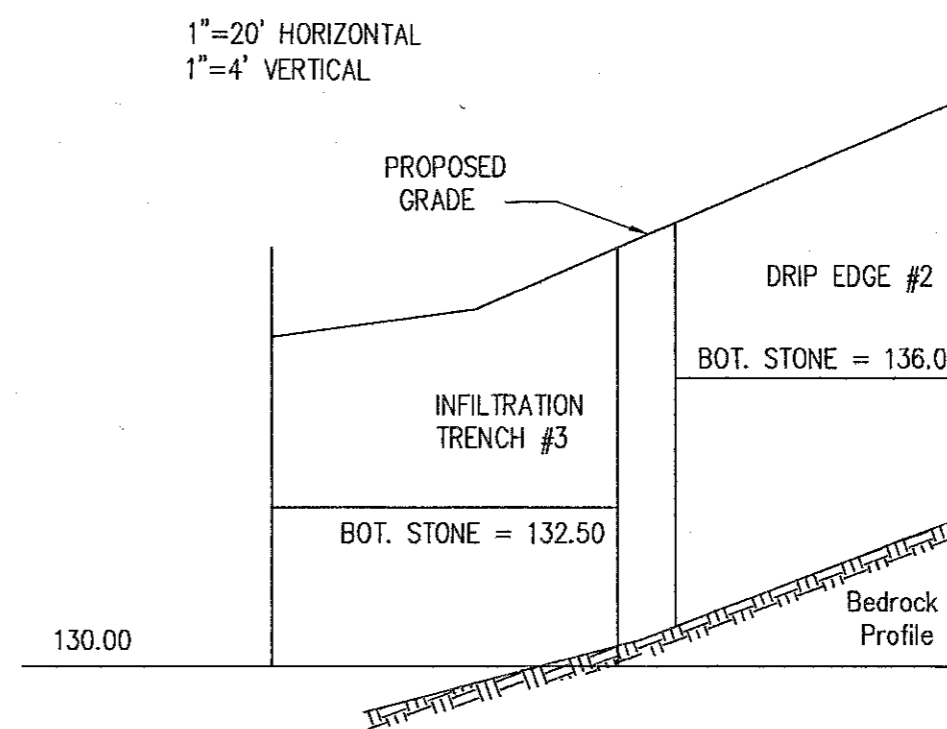

TABLE OF ELEVATIONS

BEST MANAGEMENT PRACTICE	BOTTOM OF STONE ELEVATION	ESTIMATED SEASONAL HIGH WATER TABLE
DRIP EDGE 1	140.00	134.7 TP 23-4
DRIP EDGE 2	136.00	132.9 TP 23-7
INFILTRATION TRENCH 3	132.50	129.7 TP 23-5
DRYWELL 1	138.00	133.4 TP 23-3
DRYWELL 2	136.00	132.9 TP 23-7

SECTION THROUGH DRIP EDGE 2/INFILT. TR. 3



DETAIL ROOF DRYWELL
No Scale

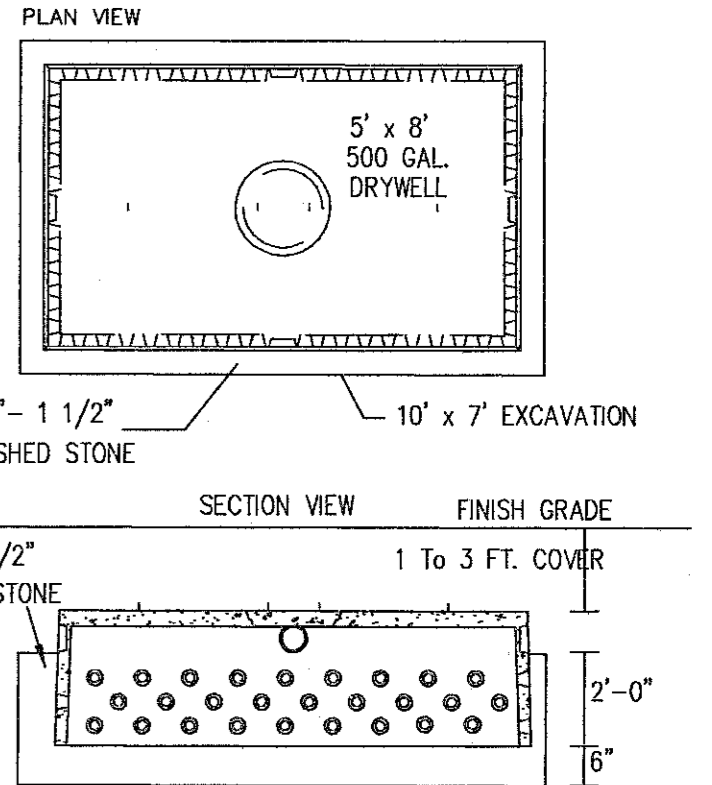

SHALLOW LEACH PITS SHALL BE EQUIVALENT TO ITEM NO. DW-JDW AS MANUFACTURED BY SHEA CONCRETE PRODUCTS, INC.

CONSTRUCTION NOTES

- PROPOSED WATER SERVICE SHALL BE 1" TYPE 'K' COPPER
- PROPOSED SEWER SERVICE SHALL BE 6" DIAMETER SCH. 40 PVC PITCHED A MINIMUM OF 1/4" PER FOOT.

GENERAL NOTES

- THIS PLAN IS THE RESULT OF AN ON THE GROUND FIELD SURVEY AND PUBLIC AND PRIVATE PLANS.
- UTILITIES SHOWN ARE BASED UPON FIELD SURVEY AND RECORD PLANS AND ARE NOT NECESSARILY INDICATIVE OF UNDERGROUND CONDITIONS.
- THE CONTRACTOR SHALL BE RESPONSIBLE FOR VERIFYING AND DETERMINING THE LOCATION, SIZE AND ELEVATION OF ALL EXISTING UTILITIES, SHOWN OR NOT SHOWN ON THESE PLANS, PRIOR TO ANY CONSTRUCTION. THE CONTRACTOR SHALL NOTIFY DIG-SAFE PRIOR TO ANY WORK. THE ENGINEER SHALL BE NOTIFIED IN WRITING OF ANY UTILITIES FOUND INTERFERING WITH THE PROPOSED CONSTRUCTION AND APPROPRIATE REMEDIAL ACTION BEFORE PROCEEDING WITH THE WORK.
- THIS PLAN IS BASED ON THE REFERENCED PLANS, DEEDS AND THE RESULTS OF A FIELD SURVEY AS OF THIS DATE. NO CERTIFICATION IS INTENDED AS TO PROPERTY TITLE OR AS TO THE EXISTENCE OF UNWRITTEN OR UNRECORDED EASEMENTS.
- THE OWNER SHALL CONFIRM COMPLIANCE WITH ALL APPLICABLE CODES AND REGULATIONS GOVERNING THE MATERIALS AND/OR METHODS OF INSTALLATION OF ANY IMPROVEMENTS DEPICTED ON THIS PLAN.
- SEE ARCHITECTURAL DRAWINGS FOR DETAILS OF BUILDING DIMENSIONS, FINISH AND MATERIALS, AND ELEVATION VIEWS.
- PLAN DATUM: NAVD 1988
- THE SITE IS LOCATED IN A ZONE X AS PER FEMA FIRM 25017C0402E DATED JUNE 4, 2010
- WETLAND RESOURCE AREA DELINEATION by BASBANES WETLAND CONSULTING FEBRUARY, 2023.

ZONING DISTRICT : RO
DEED REFERENCE: RECORD BOOK 72472 PAGE 288
PLAN REFERENCE: PLAN 276 OF 1981
ASSESSORS MAP 48 PARCEL 32-1
RECORD OWNER : K & B GILLIS FAMILY TRUST

SITE DEVELOPMENT PERMIT PLAN
LOCATED IN
BURLINGTON, MASS,

78 MOUNTAIN ROAD

PREPARED BY
EASTERN LAND SURVEY ASSOCIATES
CHRISTOPHER R. MELLO, PLS
104 LOWELL ST. PEABODY, MA 09160
(978) 531-8121

SCALE: 1"=20' FEBRUARY 1, 2023
Revised March 21, 2023

SITE PLAN
SCALE: 1"=20'

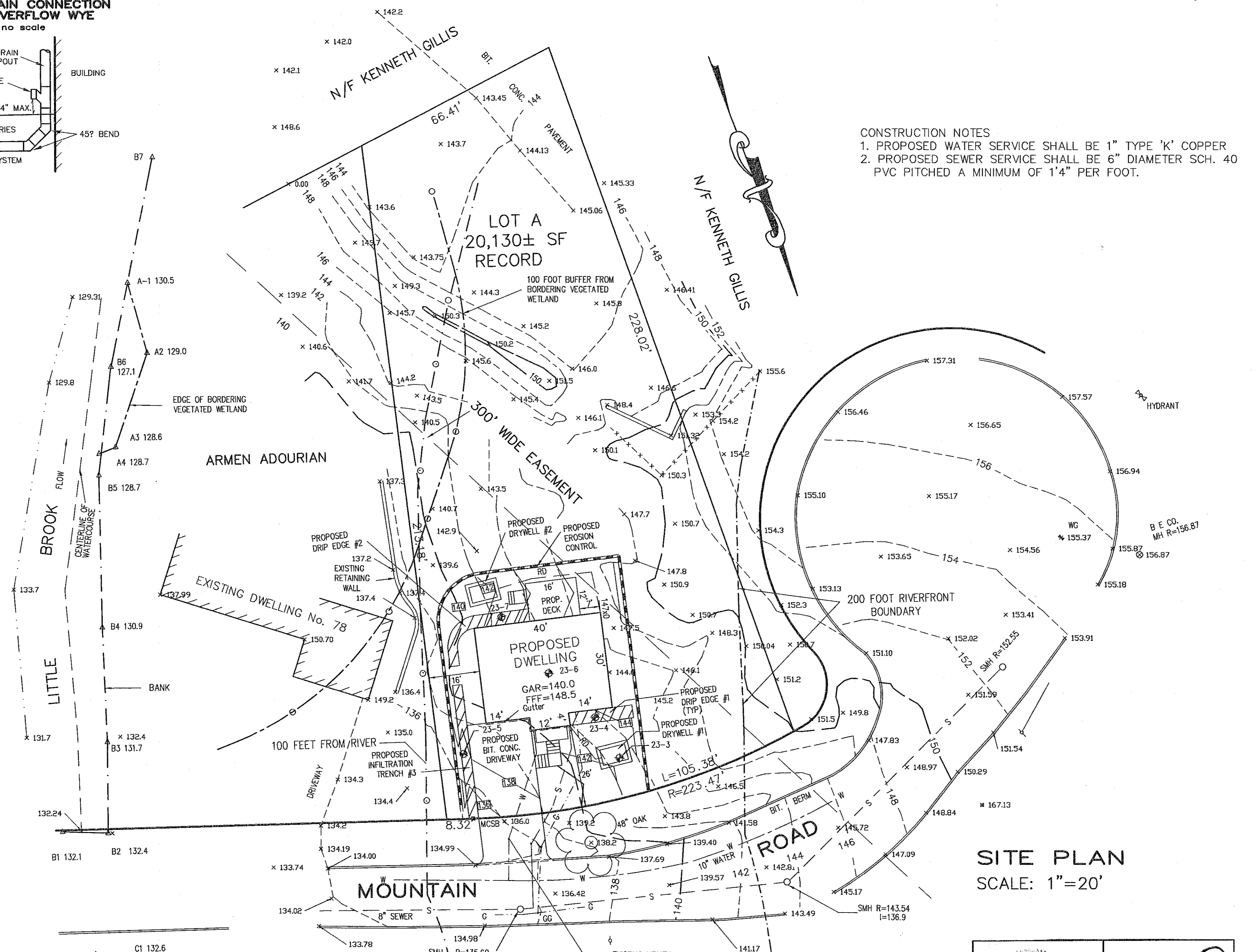

Professional seals and signatures for Christopher R. Mello, PLS 31317 and Clayton A. Morin, PE 30969.

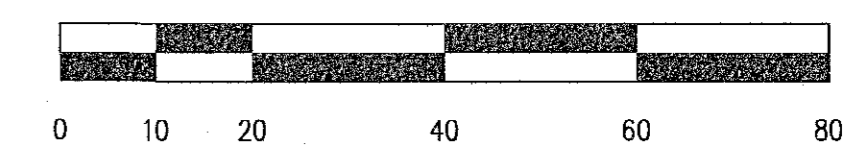

C/F20233 SITE
F 20233